

ALTERATIONS AND ADDITIONS TO: MIDLAND ELEMENTARY SCHOOL

GALIVANTS FERRY, SOUTH CAROLINA



PIKE-McFARLAND-HALL
ASSOCIATES, INC.
ARCHITECTS & PLANNERS



February 19, 2018

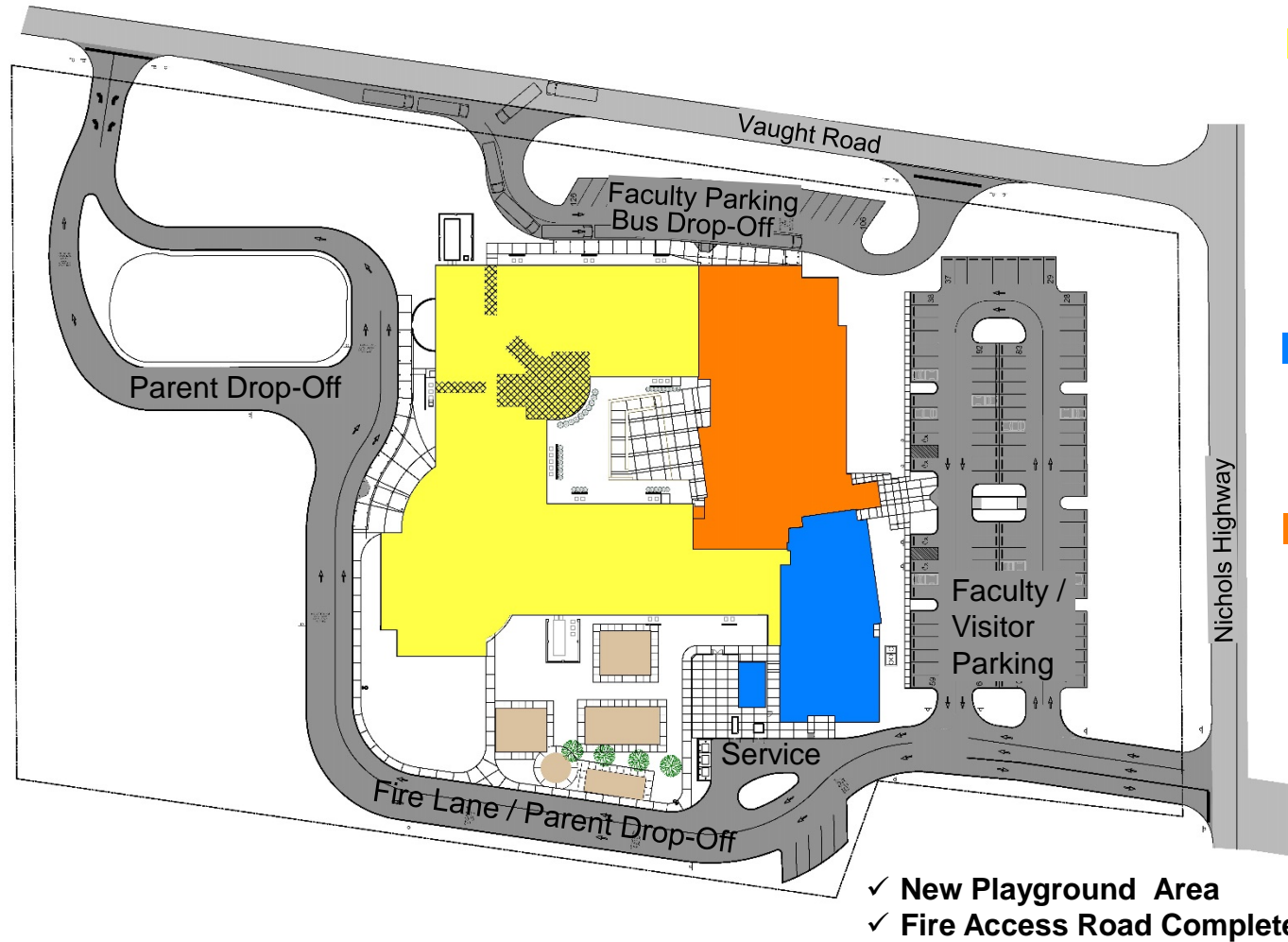

XXXX Demolished 18,000 SF
Existing Building
June 2016

Existing Building
[42,516 SF]
Renovations:
Completed - August 2017
Start of School

Site Work

95% Completed –
August 2017

New Kitchen / Dining
Energy Plant

[9,348 SF]
[671 SF]
Completed October 2017

New 2 Story Addition
[39,094 SF]

OSF Final Inspection 01/26/18

- ✓ 12 New Classrooms
- ✓ 2 Self-Contained Classrooms
- ✓ 2 Computer Labs
- ✓ Administration Suite
- ✓ Student Learning Center

FINAL SITE PLAN





**NEW FINISHES IN EXISTING
CLASSROOM WINGS**



**NEW FINISHES IN
EXISTING ART ROOM**

































STUDENT LEARNING CENTER



STUDENT LEARNING CENTER



STUDENT LEARNING CENTER



STUDENT LEARNING CENTER



CURRICULUM COACH'S OFFICE



WORKROOM



MAIL ROOM

ADMINISTRATION STORAGE





CONFERENCE ROOM

CONFERENCE ROOM





SELF-CONTAINED CLASSROOM



SELF-CONTAINED CLASSROOM



SELF-CONTAINED CLASSROOM



COMPUTER LAB



COMPUTER LAB



LLR

SOUTH CAROLINA DEPARTMENT OF LABOR,
LICENSING AND REGULATION
OFFICE OF ELEVATORS AND AMUSEMENT RIDES
P.O. Box 11329
Columbia, SC 29211
803-896-7630

CERTIFICATE OF OPERATION

The unit identified below complies with requirements
set forth in South Carolina Rules and Regulations
71-5000, et. seq., of the SC Department of LLR's
Office of Elevators and Amusement Rides:

Type of Unit: *Passenger*

Unit number: *26-01856* Maximum Capacity: *3500*

Location: *3011 Nichols Hwy*

Owner:

Operator:

Date of last inspection: *2/2/18*

Inspector: *[Signature]*

ID# *2009*

[Signature]
Administrator

NO SMOKING

POST THIS PERMIT IN A CONSPICUOUS PLACE IN EACH UNIT
SCDL/LIC 9803



TYPICAL CLASSROOM



TYPICAL CLASSROOM



RESOURCE ROOM



RESOURCE ROOM



OSF APPROVAL FEBRUARY 13



OSF APPROVAL FEBRUARY 13

MOVE-IN FEBRUARY 17TH



UNDER BUDGET

OSF APPROVAL FEBRUARY 13

MOVE-IN FEBRUARY 17TH

ALTERATIONS AND ADDITIONS TO: MIDLAND ELEMENTARY SCHOOL

GALIVANTS FERRY, SOUTH CAROLINA



■
PMH

■
**PIKE-McFARLAND-HALL
ASSOCIATES, INC.**
ARCHITECTS & PLANNERS



February 19, 2018